

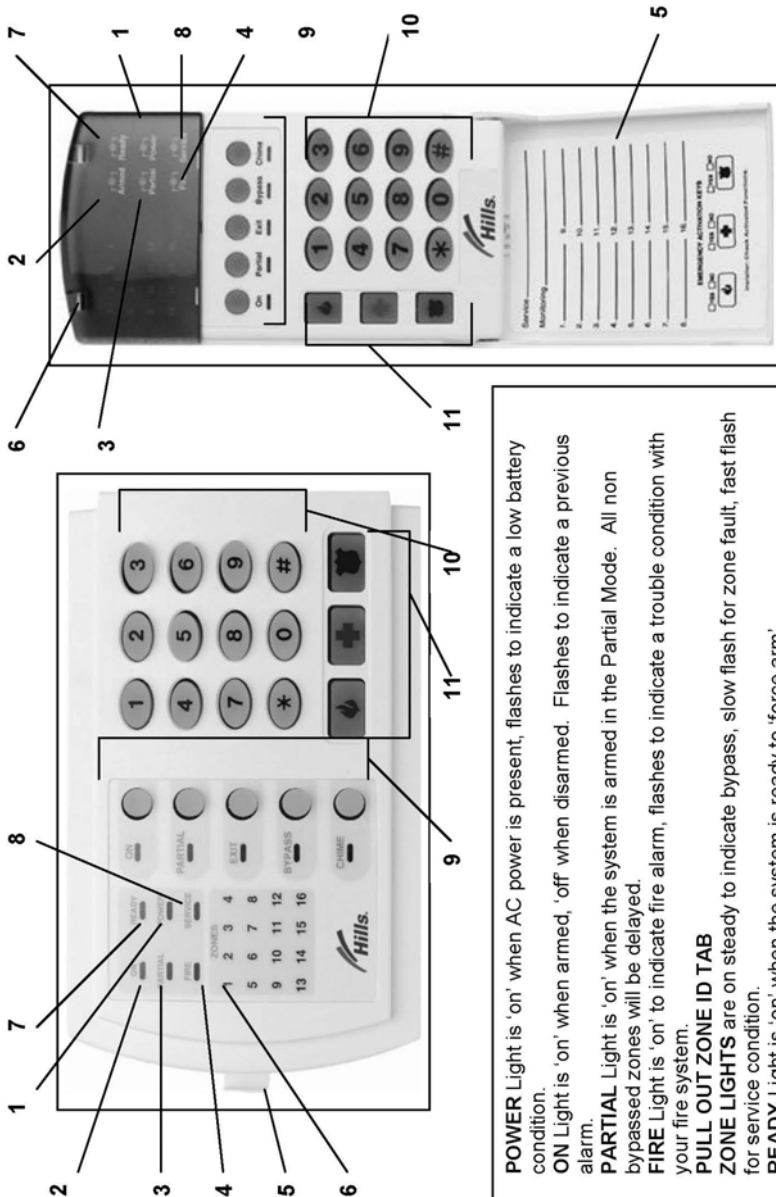

HILLS® Series LED Code Pad

User Manual

Not all features may be available on your system
 Check with your installer to find out which features are programmed



1. **POWER** Light is 'on' when AC power is present, flashes to indicate a low battery condition.
2. **ON** Light is 'on' when armed, 'off' when disarmed. Flashes to indicate a previous alarm.
3. **PARTIAL** Light is 'on' when the system is armed in the Partial Mode. All non bypassed zones will be delayed.
4. **FIRE** Light is 'on' to indicate fire alarm, flashes to indicate a trouble condition with your fire system.
5. **PULL OUT ZONE ID TAB**
6. **ZONE LIGHTS** are on steady to indicate bypass, slow flash for zone fault, fast flash for service condition.
7. **READY** Light is 'on' when the system is ready to 'force arm'.
8. **SERVICE** Light is 'on' to indicate a trouble condition with your system.
9. **5 FUNCTION KEYS** perform various functions
10. **NUMBER CODE ENTRY KEYS**
11. **EMERGENCY ACTIVATION KEYS**

TABLE OF CONTENTS

• Code Pad Diagrams	2
• Glossary of Terms	4
• Understanding the Code Pad Lights.....	5
• Code Pad Control Tones	6
• Fully arming the system – On Mode.....	7
• Fully arming the system – Quick Arm Mode.....	7
• Partially arming the system – Partial Mode	8
• Disarming – from the On or Partial Mode	8
• Bypassing – Individual Zones	9
• Group Bypass	10
• Changing & Adding User Codes.....	11
• Deleting User Code	12
• Walk Test.....	12
• User Code Authorisation.....	13
• Setting the Door Chime	13
• Exit Mode – Extend Exit Timer	14
• Code Pad Emergency Keys.....	14
• Viewing Alarm Memory.....	14
• Reset Latched Alarms	15
• Setting System Date	15
• Setting System Time.....	16
• Set Code Pad Tones	16
• Program Telephone Number	17
• Viewing Telephone Numbers.....	18
• Deleting Telephone Numbers	19
• Communicator, Battery & Siren Test	19
• Service Light.....	20
• Emergency Evacuation Plans.....	21
• Warranty Statement.....	22
• Zone List.....	Back Page

GLOSSARY OF TERMS

Authority Level: The level of access an individual has when using an alarm panel.

Central Station: Location where alarm data is sent during an alarm report.

Chime Feature: An option that allows the code pad to sound a ding-dong whenever an entry/exit door is opened.

Codes: Can be either User Codes (relating to a person) or Function Codes (a toggle switch to turn specific functions on/off). NOTE: A system may have either 99 four (4) digit codes or 66 six (6) digit codes, but not a mixture of the two.

Dialer Delay: An option that allows a delay in reporting to the central station.

Duress Code: An option that allows a special code to be sent to the central station that indicates the alarm system is being operated under duress.

Forced Arming:

An option that allows the system to be turned on (ARMED) with one or more zones open. A system that is ready to be "force armed" will flash the *ready light*. (Note: Those zones that are not ready will not create an alarm.)

Function Code: A Function Code is either a four (4) or six (6) digit code that has been programmed by the installer to operate a device.

Group Bypass: An option that allows the user to bypass multiple zones with a single operation.

Master Code: A master PIN code that can arm & disarm the alarm system, and can add and delete user PIN codes.

Partial Arm: A mode used to arm the perimeter and unused areas of an occupied premises.

Perimeter: The outer edge of the protected area, typically the windows and doors fitted with alarm sensors.

Quick Arm: An option that allows you to turn on (ARM) the security system by pressing either the [ON] or [PARTIAL] key on the code pad control (for ARMING only) as programmed by the installing company.

Universal Arming (Uni Arm): When enabled, your alarm system can automatically determine whether to arm in the Full mode or in the pre-set Partial mode by looking to see if you exit your premises or stay inside after arming your system. NOTE: This feature can be used in conjunction with "Quick Arm".

User Code: A four (4) or six (6) digit entry used to arm or disarm the system.

UNDERSTANDING THE LIGHTS

Armed Light

The *armed light* is “on” when the system is armed. The *armed light* is “off” when it is disarmed. The *armed light* will flash when there has been an alarm during the previous arm cycle.

Bypass Light

The *bypass light* is “on” when any zone in this code pad’s area is bypassed. The zone(s) that is bypassed will also be illuminated. If the *bypass light* is “off”, no zones are bypassed.

Chime Light

The *chime light* is “on” when the chime feature is “on”; “off” otherwise.

Exit Light

The *exit light* is “on” during the exit delay. Please note that the light will flash during the last 10 seconds of the exit delay as a warning that the time is running out. (The user may want to restart the exit delay if the *exit light* is flashing in order to prevent an alarm. The user may then press the [Exit] key to restart the exit delay before the delay expires.)

Fire Light

A steady *fire light* means a fire zone has been faulted. A rapidly flashing *fire light* means that a fire zone is in a trouble condition.

On Light

The *on light* is “on” when the system is armed. The *on light* is “off” when it is disarmed.

Partial Light

The *partial light* is “lit” when the system is armed in the Partial Mode. All non bypassed zones will be delayed and follow the Partial delay time. When armed in Partial Mode, the Arm, On, and Bypass lights will also be “lit”.

Power Light

The *power light* is lit if the primary power is on. The *power light* will flash if the system detects a low battery condition.

Ready Light

The *ready light* is “lit” when the system is ready to arm and “flashes” if ready to force arm. The *ready light* is off when the system is not ready to arm because of a zone(s) being faulted.

Zone Light

The *zone lights* are “off” when everything is normal. A *zone light* will be “lit” if the zone has been bypassed. If a *zone light* is “flashing”, that zone is in alarm or has been faulted. If a *zone light* is “flashing” rapidly, it means that the zone is in a trouble condition. Trouble conditions are: **Hardwire Zone Tamper; Wireless Zone Tamper, Sensor Low Battery and Sensor Loss of Supervision**

(A combination of Alarm/Fault and Tamper/Trouble will produce a rapid “flashing” light for a short period of time, followed by a slow “flashing” light.)

CODE PAD CONTROL TONES

- Beeps for all key presses Sounds a continuous tone during the entry delay time.
- Pulses when a day zone is violated while the system is disarmed.
- Pulses when a fire zone has a trouble condition.
- Beeps 3 times for trying to arm with the "Ready" light off, if "Force Arming" has not been selected.
- Beeps for 1 second or emits a "ding-dong" sound for the "Chime" feature.
- Beeps during an exit delay; beeps rapidly for the last 10 seconds of an exit delay; and beeps 1 second at the end of the exit delay.
- Pulses when the armed status changes and the AC power is off.
- Pulses when the armed status changes and any zone(s) is bypassed.
- Pulses when the armed status changes and a low battery is detected.
- Pulses when the armed status changes and a tamper condition is detected. Beeps to indicate telephone line cut, if selected.
- Pulses when one or more of the following conditions are detected: zone or box tamper, low battery, AC power fail, or expander trouble.

Entering a valid code will silence the code pad sounder when it is pulsing. Please contact your installer if a trouble condition exists.

FULLY ARMING THE SYSTEM – ON MODE

ON is used when the user is away from the premise and wants the interior protected. To arm in the ON Mode:

1. Close all protected doors and windows. Ready light will light when all protected zones and sensors are secure. NOTE: If any zones are bypassed, a sensor in that zone can be violated without affecting the ready light. The security system will not arm if the ready light is not on. If the power light is off, you have no AC power. Restore power if possible. If not, contact your installation company.

2. Enter your 4 digit user code to arm the system. The armed and exit lights will illuminate. You may now leave the building via the designated exit path.

Note: The exit light will flash rapidly for the last 10 seconds of the exit delay as a warning to the user that the exit time is about to expire.

Key Sequence

Operation

1

2

3

4

Example shows a User code of 1234 being used to set the system to the ON Mode.

FULLY ARMING THE SYSTEM – QUICK ARM MODE

Quick Arm is used when the person arming the alarm system does not have a user code, is leaving the premises and wants the interior protected. To arm in the Quick Arm Mode:

1. Close all protected doors and windows. Ready light will light when all protected zones and sensors are secure. NOTE: If any zones are bypassed, a sensor in that zone can be violated without affecting the ready light. The security system will not arm if the ready light is not on. If the power light is off, you have no AC power. Restore power if possible. If not, contact your installation company.

2. The [ON] key to arm the system. The armed and exit lights will illuminate. You may now leave the building via the designated exit path.

Note: The exit light will flash rapidly for the last 10 seconds of the exit delay as a warning to the user that the exit time is about to expire.

Key Sequence

Operation

ON

Example shows ON key being used to set the system to the Quick Arm Mode.

PARTIALLY ARMING THE SYSTEM – PARTIAL OR HOME MODE

Home mode allows you to temporarily exclude some rooms from security arming. For example, you may wish to exclude bedrooms at night when they are in use. Home mode is also used for protecting exterior doors and windows (the home perimeter) when the user is inside.

Partial is used when the user is inside the premise and wants protection around the perimeter. Listed below are the steps to arm in the Partial mode:

1. Close all protected doors and windows. Ready light will light when all protected zones and sensors are secure. NOTE: If any zones are bypassed, a sensor in that zone can be violated without affecting the ready light. The security system will not arm if the ready light is not on. If the power light is off, you have no AC power. Restore power if possible. If not, contact your installation company.
2. Press the [PARTIAL] key. The bypass light will illuminate if any zone(s) is bypassed. The light(s) corresponding to the bypassed zone(s) will illuminate, alerting the user that a zone(s) may be unprotected and can be faulted without an alarm.

Key Sequence

Operation



PARTIAL

Press the Partial key to partially arm your premises

DISARMING – FROM THE ON OR STAY MODE

When you enter the protected area through one of the designated Entry/Exit doors, the code pad control will sound a solid continuous tone for the duration of the entry delay time, or until you enter a valid code. After entering a valid code the red armed light will go off and the tone will stop. The security system is now DISARMED. If a valid code is not entered before the end of the entry delay, an alarm will occur. (NOTE: If the red armed light is flashing during the entry delay, the alarm system has been activated in your absence. Leave the building immediately and call your alarm company and/or the police from a safe location.)

Key Sequence

Operation



1



2



3



4

Enter your user code to disarm the system from the On or Partial mode.

BYPASSING – INDIVIDUAL ZONES

Bypassing is used to temporarily exclude one or more zones that would normally be protected. For instance, a pet may need to be left in a part of the house that is usually protected. If you wish to bypass one or more zones, this must be done while the system is in the disarmed state. The following steps are used for bypassing zones. Once you have Bypassed the zone(s) you may Arm the system via the **ON** or **PARTIAL** Mode. When your security system is disarmed, any zones that has been temporarily isolated or bypassed will be reset, and will therefore be protected when the system is armed again. **To manually un-bypass zones, perform the bypassing procedure on a zone that is already bypassed. The corresponding light for that zone will go off when un-bypassed.**

Key Sequence



Operation

This example shows a user bypassing zones 4 and 5.

1. Press the **[BYPASS]** key.
2. (Optional) Enter a user code. (The bypass light flashes.)
3. Enter a 2-digit zone indicating the zone you wish to bypass.
(Example: Press the [0] and the [4] key for zone 4, press [0] and the [5] for zone 5.) The corresponding light for that zone will turn on when bypassed.
4. Press the **[BYPASS]** key again.
NB: Pleased check with your security installation company to determine if a user code is required.

GROUP BYPASS

By pressing the **[BYPASS]** key, followed by the [0][0] key, then the **[BYPASS]** key again, all zones that are designated as group bypass zones will be bypassed. Now you can arm your system in either the **[ON]** or **[PARTIAL]** mode. Once armed pressing the **[BYPASS]** key again will toggle the bypassed zones on and off.

Key Sequence

Operation



1. Press the **[BYPASS]** key.
2. Enter a user code. (The bypass light flashes.)
3. Press the [0]-[0] keys. The group bypass zone lights will turn on when bypassed.
4. Press the **[BYPASS]** key again.
NB: Please check with your security installation company to determine if a user code is required.

CHANGING & ADDING USER CODES

On occasion you may need to change your arm & disarm codes, either as a security measure or for your own convenience.

User Codes are 4 digits long and must all be different to each other. A master Code must be used to Change and Add user codes. The default master code is user code one **[01]** with a code of **[1234]**. Any user code can be assigned as a master code (See User Code Authorisation). Note the system must be disarmed before user codes can be changed or added.

Key Sequence

Operation

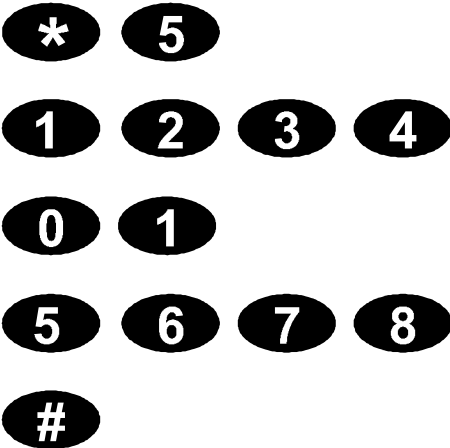

1. Press [*] and [5].
2. Enter an existing master code.
3. Enter the user code to add or change.
4. Enter the new four-digit user code.
5. Repeat steps 3 and 4 for additional user codes.
5. Press [#] when completed.

DELETING A USER CODE

You may be required to delete a user code, for example, when a member of the household leaves home, or the home is purchased from another family.

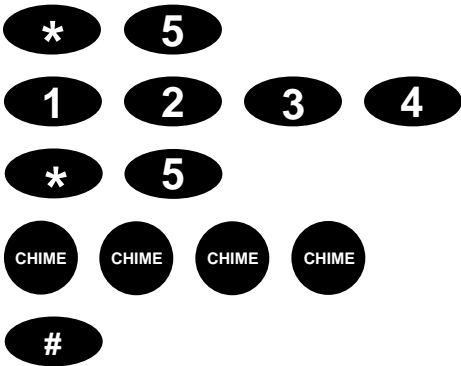
Key Sequence	Operation
	<ol style="list-style-type: none">1. Press [*] and [5].2. Enter an existing master code.3. Enter the user code to be deleted (e.g. user code three 3)4. Press the [Chime] key four (4) times to delete the user code.5. Repeat steps 3 and 4 for additional user codes.6. Press [#] when completed.

WALK TEST

Walk test is used to test the functionality and should be performed regularly. When in walk test mode the code pad transmits the chime sound each time a zone is activated, and will light the activated zone number in the code pad for the duration of the walk test period. You must exit the walk test mode when you have completed testing or are satisfied the zones function correctly.

Note: the alarm system will not report to the control room during the walk test.

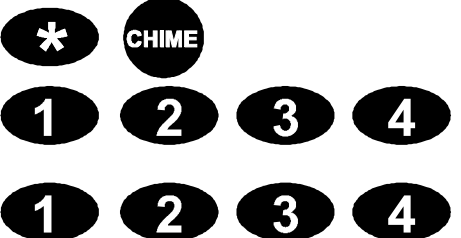
Key Sequence	Operation
	<ol style="list-style-type: none">1. Enter [*] [CHIME].2. Enter a master code. The system is now in walk test mode.3. Walk past each motion sensor and return to the code pad to check each zone light to validate the sensors are working correctly.4. Enter a master code to exit walk test. If no master code is enter walk test mode will automatically exit in 15 minuets.

USER CODE AUTHORISATION

Any user code can be assigned the master code status to allow that user to change or add other codes and provide access to other system functions.

Key Sequence	Operation
<p>The key sequence is displayed as a grid of buttons: Row 1: * 6; Row 2: 1 2 3 4; Row 3: 0 2; Row 4: 4; Row 5: *; Row 6: # #.</p>	<p>Example shows enabling user two [02] as a master code.</p> <ol style="list-style-type: none"> 1. Press [*] [6]. 2. Enter an existing master code. 3. Enter the user code to have changed to a master code. 4. Press [4] key. LED 4 will light up to indicate the user is now a master code. If LED 4 is not lit then it is a normal user code. 5. Repeat steps 3 and 4 for additional user codes. 6. Enter [*] 7. Enter [#][#] when completed.

SETTING THE DOOR CHIME

Chime Mode provides only an audio warning at the premises. A ding-dong is sounded from the code pad when the protected area is entered, for example, when an infant opens the door.

The door chime is turned on or off by pressing the [CHIME] key while the system is in the disarmed state. If the chime is on, the chime light will be lit. If the chime is off, the chime light will be off. Each press of the [CHIME] key will toggle the chime feature on/off. Chime mode must be programmed by your security Installation Company. Tell the installer if Chime mode is required for any areas.

Key Sequence	Operation
<p>The key sequence is a single button labeled CHIME.</p>	<p>Press the [CHIME] key to turn on or turn off the chime feature.</p>

EXIT MODE – EXTEND EXIT TIMER

Exit mode is used when you have already armed your Security System, but need to extend your exit time. Pressing the exit button will re-start your exit time, but you may only press Exit button twice. The code pad will beep faster in the last ten (10) seconds as a warning.

Key Sequence

A circular button with the word "EXIT" in white capital letters on a black background.

Operation

Press [Exit] key to extend the exit time.

Code Pad Emergency Keys

Three (3) emergency features are available to be programmed into your code pad to provide support in the areas of personal safety: Medical, Police (duress) and Fire arm. You must hold these keys for two (2) seconds to activate these functions. You should press these keys only in an emergency situation that requires response by emergency personnel. Check with your security installation company to find out if your system is programmed for these activation keys.

Key Sequence



Operation

Press this key and hold for two (2) seconds to activate the fire alarm.

Press this key and hold for two (2) seconds to activate the medical/auxiliary alarm.

Press this key and hold for two (2) seconds to activate the police/duress (panic/hold-up) alarm.

VIEWING ALARM MEMORY

Whenever an alarm activation occurs on your system all zones that were in alarm during that activation will be held in memory. The last alarm activation can be reviewed via the function listed below. I.e. You can see which area has activated the alarm.

Key Sequence



Operation

The alarm memory feature will flash those zone/s that created alarms and will light steady the zones that were bypassed during the last alarm.

RESET LATCHED ALARMS

Reset Latched Alarms function resets smoke detectors, zone troubles and zone tamper alarms. Note: If the code pad begins beeping, the reset did not execute properly. Enter your code to silence the code pad. Wait a few minutes and repeat the reset function to attempt another reset. If the code pad still beeps after repeated attempts, please contact your installer.

Key Sequence

Operation

1**2****3****4*********7**

1. Enter you code to silence the code pad sounder.

2. Press [*] [7] to activate the reset function.

SETTING SYSTEM DATE

Key Sequence

Operation

*******9****6****1****2****3****4****2****0****6****1****1****0****7****#**

Example shows setting date as Monday, June 11, 2007.

1. Press [*] [9] [6] keys.

2. Enter the master code.

3. Enter the day of the week (1=Sunday, 7=Saturday).

4. Enter the month code. Must be two (2) digits. E.g. [0][6] for June.

5. Enter the day code. Must be two (2) digits. E.g. [1][1] for the 11th day.

6. Enter the last two (2) digits of the year code. E.g. [0][7] for 2007.

7. Press [#] to exit. Your date is now set.

SETTING SYSTEM TIME

Key Sequence	Operation
	<p>Example shows setting time at 9.30am.</p> <ol style="list-style-type: none"> 1. Press [*] and [9][7] keys. 2. Enter the master code. 3. Enter the hour code. Must be two (2) digits. E.g. [0][9] for 9am. 4. Enter the minutes code. Must be two (2) digits. E.g. [3][0] for 30 minutes. 5. Press [#] to exit. Your time is now set.

SET CODE PAD TONES

Each code pad can have its sounder tone frequency adjusted to your individual requirements. Follow the steps bellow to adjust the code pad sounder.

Key Sequence	Operation
	<ol style="list-style-type: none"> 1. Enter [*] [0] to start the code pad tone adjustment. The code pad sounder will sound at the current set frequency. 2. Enter the one [1] key to raise the tone or the two [2] key to lower the tone. 3. Enter [#] to exit and save the selected code pad tone.

PROGRAM PHONE NUMBERS

You may have a requirement where, in the instance of alarm activation, you want the panel to dial a particular phone number. E.G. Your mobile phone.

There are three (3) numbers that can be viewed, entered/changed or deleted. Only numbers set to 'pager' or 'siren tone' telephone formats can be modified by you. One of these formats must have been programmed by the alarm panel installer for you to access this feature. Contact your security installation company to ask if the 'pager' or 'siren tone' format was programmed for your use. When confirmed use the following:

Phone number 1 is [*][4][1] Phone number 2 is [*][4][2] Phone number 3 is [*][4][3]

To program a new phone number you must do the following.

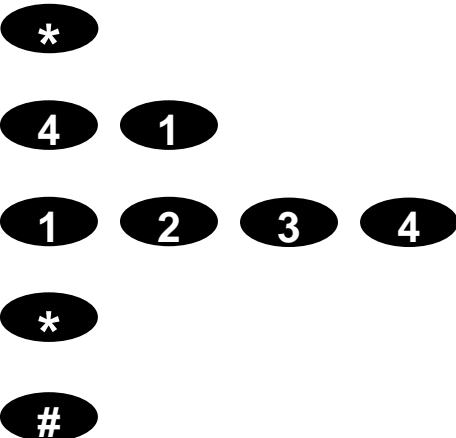
Key Sequence	Operation
	<p>Example shows programming phone number 1.</p> <ol style="list-style-type: none"> 1. Press [*] and [4] [1] for phone number 1. 2. Enter the master code. You are now in the view mode, and the first phone digit will be displayed. (Use the following table to read the code pad lights). 3. Press the [*] key to move to the next digit(s). 4. Press [#] to end and exit.

Key	Phone Digit
[1]	1
[2]	2
[3]	3
[4]	4
[5]	5
[6]	6
[7]	7
[8]	8
[9]	9
[0]	0
[On]	Star (*)
[Partial]	Hash (#)
[Exit]	4 Sec delay
[Bypass]	Disable
[Chime]	Pulse Dialling

VIEWING TELEPHONE NUMBERS

You may wish to check the phone numbers that have been programmed for your security system.

Key Sequence

Operation

*

4

2

1

2

3

4

#

The following example is for phone number 2.

1. Press [*] and [4] [2] for phone number 2.
2. Enter [4] [2] for the location of phone number 2.
3. Enter the master code.
4. Enter the phone number, not exceeding twenty (20) digits. (Use the table below to determine the key values).
5. Press [#] to end and exit.

Zone Light	Phone Digit
Zone 1	1
Zone 2	2
Zone 3	3
Zone 4	4
Zone 5	5
Zone 6	6
Zone 7	7
Zone 8	8
Zone 9	9
Zone 10	0

Light	Phone Digit
[Fire]	9
[Service]	Star (*)
[On]	Hash (#)
[Exit]	4 Sec Delay
[Bypass]	Disable
[Chime]	Pulse Dialling

DELETING TELEPHONE NUMBERS

You may need to delete a phone number you have previously chosen. For example, if you cancelled a mobile phone account.

Key Sequence	Operation
	<p>Example shows deleting phone number 3.</p> <ol style="list-style-type: none">1. Press [*] and [4] [3] for phone number 3.2. Enter the master code.3. Press the [Bypass] key to delete the saved number.4. Press [#] to end and exit.



COMMUNICATOR, BATTERY & SIREN TEST

This test will only be performed if the installer has programmed this option on. The test conducts a communicator test (once), a battery test and siren test. The communicator, battery and sirens should be tested regularly. Contact your security installation company to find out if this test is available.

Key Sequence	Operation
	<ol style="list-style-type: none">1. Enter keys [*] [4] [4] to initiate the test. Note: Sirens will sound during this test.2. Enter a user code to end the test.

SERVICE LIGHT

The **service light** will be “lit” if the security system requires service. If the **service light** is “lit”, press the [*] key followed by the [2] key to determine the service condition. One or more zone lights will illuminate indicating what service(s) is required. Call your local security installation company immediately for these problems. Below is a listing of what each light means in a service condition.

Key Sequence	Operation
 	1. Enter keys [*] [2] and use the table below to identify the service condition.

LIGHT	Condition								
1	<p>SYSTEM FAULT - Press the [1] key. The <i>zone light(s)</i> that is illuminated corresponds to the system fault(s) below:</p> <table border="1"> <tbody> <tr> <td>1 Over Current Fault</td> <td>5 Expander Low Battery</td> </tr> <tr> <td>2 Siren Trouble</td> <td>6 Expander Box Tamper</td> </tr> <tr> <td>3 Box Tamper</td> <td>7 Expander Trouble</td> </tr> <tr> <td>4 Expander Power</td> <td>8 Reserved</td> </tr> </tbody> </table> <p>Note: Faults 1 & 2 are global in nature and will affect all areas of a multi-area system. Press the [#] key to return to the 1 of 8 <i>service lights</i>.</p>	1 Over Current Fault	5 Expander Low Battery	2 Siren Trouble	6 Expander Box Tamper	3 Box Tamper	7 Expander Trouble	4 Expander Power	8 Reserved
1 Over Current Fault	5 Expander Low Battery								
2 Siren Trouble	6 Expander Box Tamper								
3 Box Tamper	7 Expander Trouble								
4 Expander Power	8 Reserved								
2	ZONE TAMPER - Press the [2] key and the <i>zone light(s)</i> will illuminate showing the zone(s) that is tampered. Press the [#] key to return to the 1 of 8 <i>service lights</i> .								
3	ZONE LOW BATTERY - Press the [3] key. The <i>zone light(s)</i> will illuminate showing which zone(s) has a low battery. This only applies to wireless zones. Press the [#] key to return to the 1 of 8 <i>service lights</i> .								
4	ZONE LOSS OF SUPERVISION - Press the [4] key and the <i>zone light(s)</i> will illuminate showing which zone(s) has loss of supervision. This only applies to wireless zones. Press [#] key to return to the 1 of 8 <i>service lights</i> .								
5	ZONE TROUBLE - Press the [5] key and the <i>zone light(s)</i> will illuminate showing which zone(s) has a trouble condition. Press the [#] key to return to the 1 of 8 <i>service lights</i> .								
6	TELEPHONE LINE TROUBLE/LINE CUT - There is telephone line trouble or the telephone line has been cut. The <i>service light</i> will remain lit until the telephone trouble clears and a user code is entered. Note: This fault is global in nature and will affect all areas of a multi-area system.								
7	FAILURE TO COMMUNICATE - There is a failure to communicate between your system and the central station. Note: This fault is global in nature and will affect all areas of a multi-area system.								
8	LOSS OF SYSTEM TIME - There has been a loss of power and your system clock needs to be reset. Instructions are on page 15. Note: This fault is global in nature and will affect all areas of a multi-area system.								
Exit	To exit the Service Light Mode - press the [#] key.								

EMERGENCY EVACUATION PLANS

An emergency evacuation plan should be established for an actual fire alarm condition. For example, the following steps are recommended by the National Fire Protection Association and can be used as a guide in establishing an evacuation plan for your building.

Draw up a floor plan of your home. Show windows, doors, stairs, and rooftops that can be used for escape. Indicate each occupant's escape routes. Always keep these routes free from obstruction. Determine two means of escape from each room. One will be the normal exit from the building. The other may be a window that opens easily. An escape ladder may have to be located near the window if there is a long drop to the ground below. Set a meeting place outdoors for a headcount of the building occupants. Practice escape procedures. In a home, sleep with bedroom door closed; this will increase your escape time. If you suspect fire, test the door for heat. If you think it is safe, brace your shoulder against the door and open it cautiously. Be ready to slam the door if smoke or heat rush in. Practice escaping to the outdoors and meeting in an assigned spot. Call the Fire Department from a neighbour's phone.

NOTE: After the installation of your Security System has been completed, notify your local Fire and Police Departments to give them your name and address for their records. Early warning fire detection is best achieved by the installation of fire detection equipment in all rooms. also have other rights which vary from State to State.

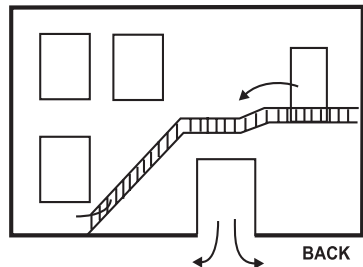
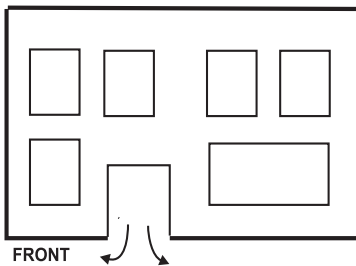
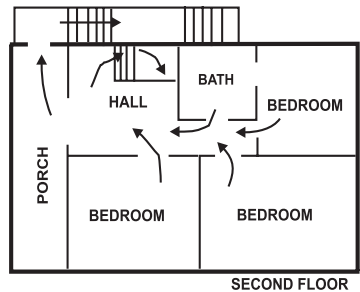
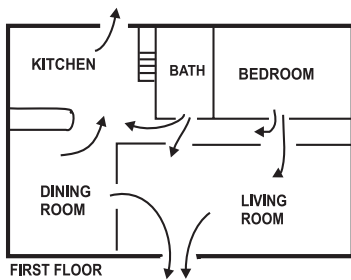

WARRANTY STATEMENT

Hills Industries guarantees this product against defective parts and workmanship for twenty-four (24) months from the date of purchase. If any defect appears during the warranty period return it to place of purchase. Hills Industries assumes no liability for consequential or indirect damage and accepts no responsibility for repairing damage to the product caused by misuse, careless handling, or where repairs have been made by others.

No other guarantee, written or verbal, is authorized by or on behalf of Hills Industries.

Please refer to your security installation company for current warranty information.

WARNING NOTICES

This product is to be installed by qualified SERVICE PERSONNEL only

The equipment should only be operated with an approved power adapter with insulated live pins.

CAUTION – RISK OF EXPLOSION IF BATTERY IS REPLACED BY AN INCORRECT TYPE. DISPOSE OF BATTERIES ACCORDING TO THE INSTRUCTIONS. CONTACT YOUR INSTALLER FOR REPLACEMENT BATTERIES.



N4131

When installed as directed, this product conforms to the standards set by Standards Australia on behalf of the Australian Communications Authority (ACA).

Programmed Phone Number 1: _____
 Programmed Phone Number 2: _____
 Programmed Phone Number 3: _____

**ENTRY /
EXIT 24**
STAY MODE
24 HOUR

ZONE LIST		ENTRY / EXIT 24	STAY MODE	24 HOUR
1				
2				
3				
4				
5				
6				
7				
8				
9				
10				
11				
12				
13				
14				
15				
16				
17				
18				
19				
20				
21				
22				
23				
24				

For Service Contact